

Product Info Sheet



Toll-Free: 800-420-1062

www.snobootz.com

Snobootz are a revolutionary, new, patent-pending, winter traction device for passenger cars and light trucks. The Snobootz system consists of a durable, coated-fabric boot which wraps the tire and contains bonded, rubber traction pads with embedded steel cleats for ice traction.

- **Snobootz are faster and easier to install than snow chains.** Snobootz can be installed in about one-third the time of chains, minimizing the driver's exposure to roadside hazards.
- **Snobootz provide traction comparable to snow chains.** Independent testing shows that vehicles with Snobootz can accelerate on ice and climb ice-covered grades as well as vehicles with chains.
- **Snobootz won't damage your tires and wheels.** Snobootz do not have any metal in contact with your tire sidewalls, so there's no chance of damaging your tires or scratching your wheels.
- **Snobootz weigh less than half as much as snow chains.** A lighter, easier-to-use traction device that's more user-friendly is more likely to be used when needed.
- **Snobootz provide dry road durability comparable to chains.** The rubber traction pads that bear the weight of the vehicle provide for durability that is equal to or superior to that of snow chains.

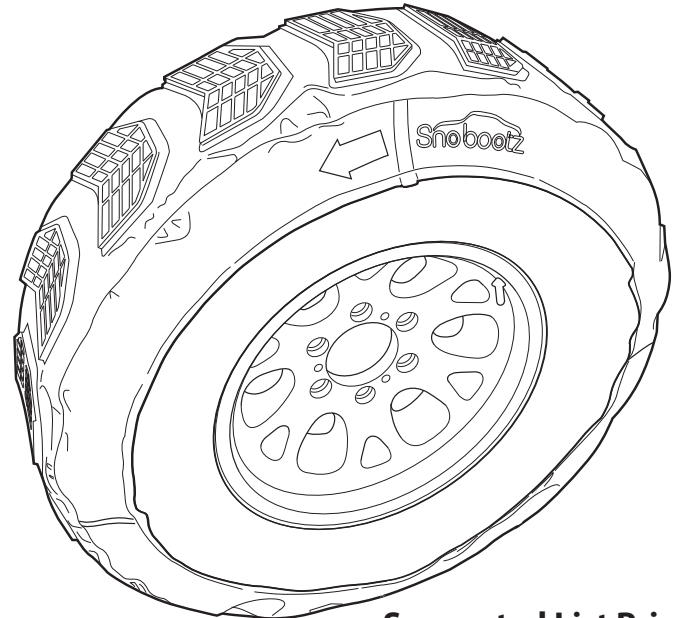

Suggested List Price
\$249.95

Easy to Install

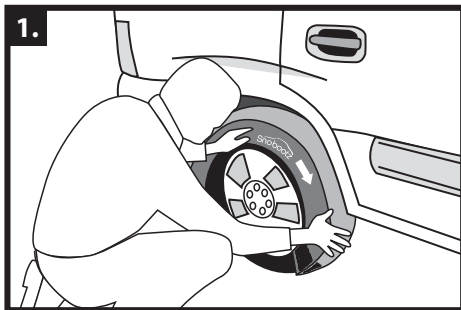

1. **Drape Snobootz over the tire.** Tuck the boot under the contact patch at the front of the tire.

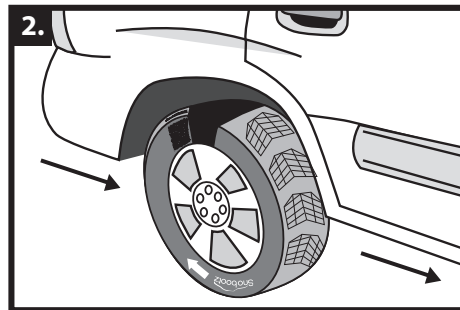

2. **Drive forward a few feet** until the split in the boot is at the top of the tire.

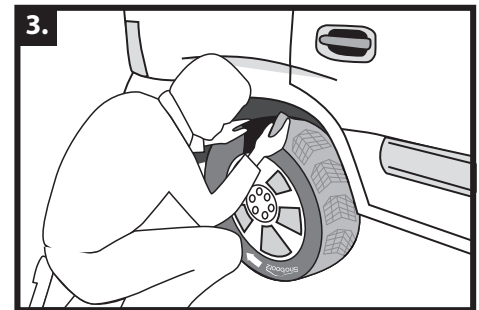

3. **Attach hook-and-loop fastener** as tightly as possible. You're ready to roll!

Fits Tight Clearances

Snobootz fit tightly against the tire to allow use on front wheel drive vehicles and others with limited clearance around the tire. Only 1/2" of clearance is needed. In order to fit Snobootz, you need to have enough clearance to reach your hands above the tire and touch the back sidewall.

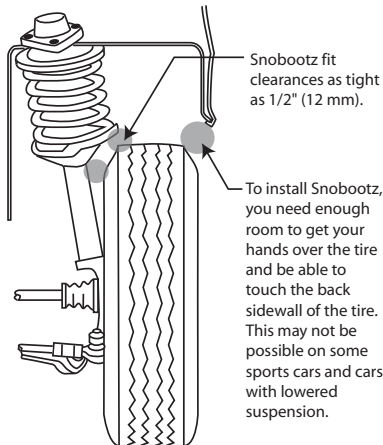

Metal Claws Grip Ice

Each rubber pad has two metal claws imbedded into it for outstanding traction on ice. The prongs on each ice claw extend through the boot to engage with the tire's tread, reducing the chance of the tire spinning inside the boot.

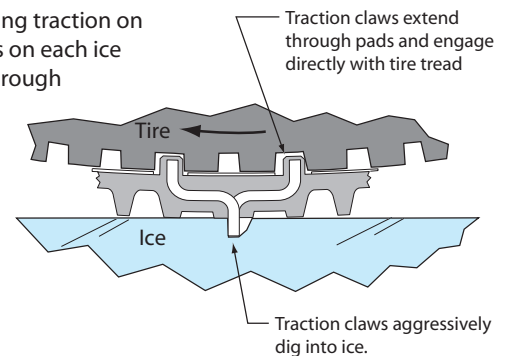

Product Info Sheet

Snobootz Enhance Safety - Greater traction & shorter braking distances.

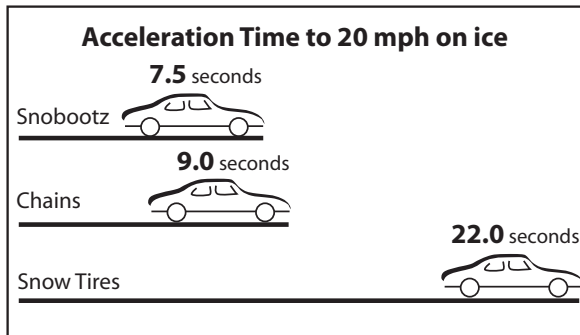

**Snobootz 16% quicker to 20 mph than chains,
66% quicker than snow tires on ice**

(Rear wheel drive SUV, tested by Michigan Tech Univ.)

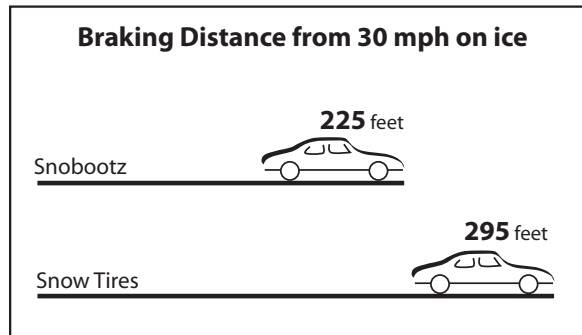

**Snobootz stop 24% shorter than
all-season radial tires on ice**

(Front wheel drive car, tested by Michigan Tech Univ.)

Tire Size Fit Chart (2008 season)

Tire Size	Part No.
215/70-14	66-17
225/70-14	68-18
225/75-14	68-18
235/70-14	68-20
255/75-14	75-21
195/65-15	63-18
205/60-15	63-18
205/70-15	66-17
215/65-15	66-17
215/70-15	68-18
225/65-15	68-20
235/60-15	68-20
235/65-15	68-20
235/75-15	72-19
255/70-15	75-21
265/75-15	80-21

Tire Size	Part No.
195/55-16	63-18
195/65-16	66-17
205/55-16	63-18
205/60-16	66-17
205/70-16	68-18
215/60-16	66-17
215/65-16	68-18
225/60-16	68-20
225/75-16	75-18
235/55-16	68-20
235/60-16	68-20
235/70-16	72-19
245/70-16	75-21
245/75-16	77-19
255/65-16	75-21
255/70-16	72-19

Tire Size	Part No.
265/70-16	80-21
265/75-16	81-21
205/55-17	66-17
215/60-17	68-18
225/55-17	68-20
225/65-17	72-19
235/70-17	77-19
235/80-17	81-21
245/65-17	75-21
245/70-17	77-19
255/65-17	77-19
255/70-17	81-21
255/75-17	81-21
265/65-17	80-21
265/70-17	81-21
215/50-18	68-20

Tire Size	Part No.
215/55-18	68-18
225/50-18	68-20
225/60-18	72-19
235/60-18	75-21
235/65-18	77-19
255/70-18	81-21
225/55-19	72-19
235/55-19	75-21
235/60-19	77-19
245/55-19	75-21
245/65-19	81-21
255/60-19	81-21
245/45-20	75-21

Actual tire sizes vary depending on manufacturer and model. Always test fit Snobootz to ensure proper size and overlap before first use.

Warranty & Return Policy Summary

Snobootz are warranted against defects in materials and/or workmanship for one year from date of purchase. See warranty certificate for full details. Please keep in mind the following cautions.

- The product is designed for the specific purpose of improving traction on snow- and ice-covered road surfaces.
- The product is not intended for off-road use.
- The product is not intended for extended use on dry pavement.
- The product is not to be used at speeds above thirty (30) miles per hour (50 km/h).
- Buyer accepts full responsibility for state and local laws governing the use of the product on public highways.
- Do not use product that is damaged.
- Drivers should always exercise caution and be observant of adverse driving conditions. The use of the product is not a substitute for safe driving or proper judgment by the vehicle driver.

Your Snobootz may be returned for a full refund (less shipping costs) if the product does not fit your tires properly or if there is insufficient clearance to provide proper fit. In order to return the product, the following requirements must be met:

- You must notify us of your desire to return the product within 21 days of the date of purchase. This time limitation is in place to prevent people from buying the product at the beginning of the season and returning them at the end of the season if they didn't use them.
- You purchased the product directly from Navimetrix (manufacturer of Snobootz). If you purchased from a distributor, you must contact them for return processing.
- All goods and packaging must be in new, clean, and resalable condition.

In order to take advantage of our return policy, we recommend that you test fit your Snobootz in a dry, clean place soon after you receive them to confirm that they fit your tires and vehicle.